



Stratfield Road

Borehamwood, WD6 1UR

£425,000 Freehold

A newly decorated and absolutely stunning two bedroom end of terrace house moments from Borehamwood High Street with it's mainline train station. The property comprises of an open plan lounge and kitchen, downstairs w/c, two bedrooms and bathroom. Externally the property boasts off street parking and front and rear gardens.

- Two Bedroom House
- Moments from the Town & Station
- Driveway
- Downstairs W/C
- Excellent Condition
- Chain Free

Viewing

Please contact our Carrington Estate Agents Office on 02089531818 if you wish to arrange a viewing appointment for this property or require further information.



Floor Plan

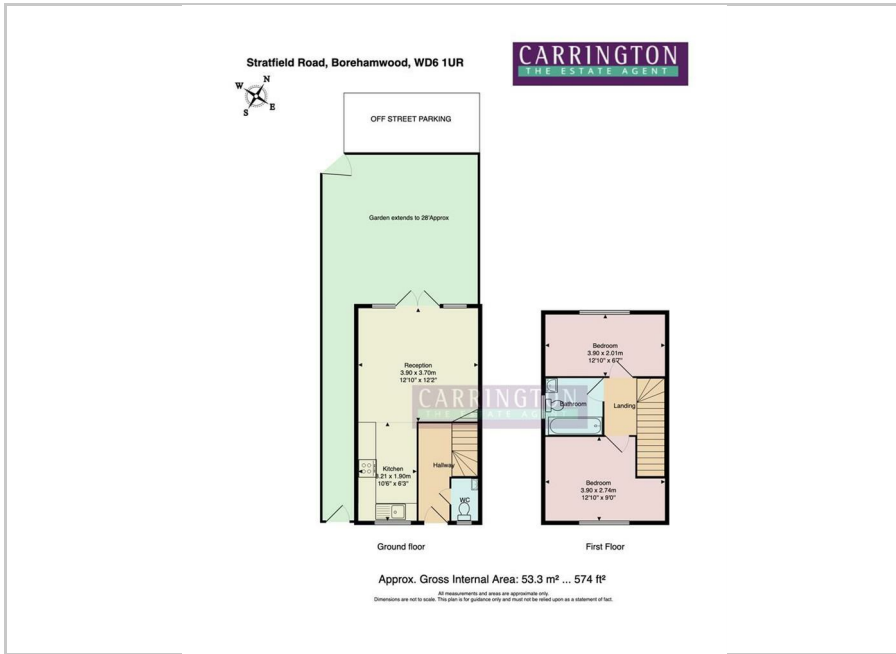

Area Map

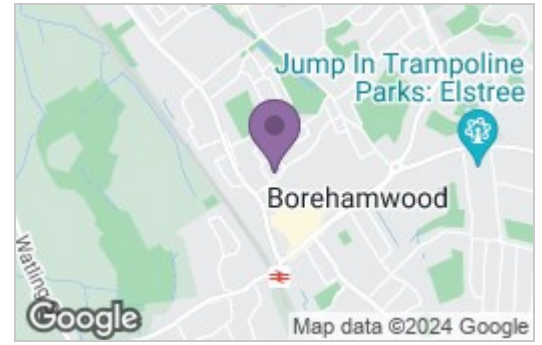

Energy Efficiency Graph

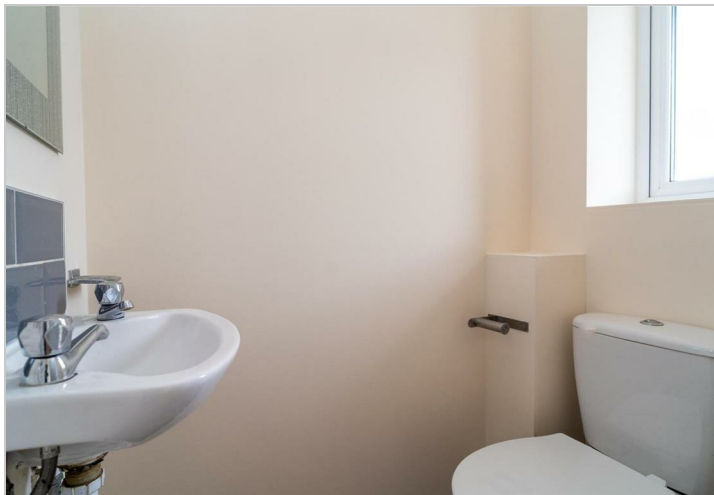
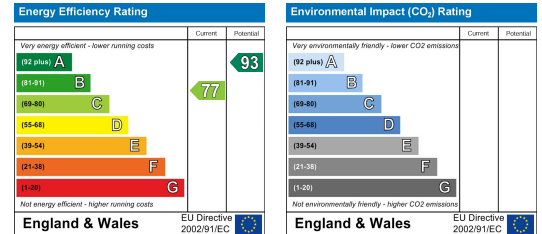

These particulars, whilst believed to be accurate are set out as a general outline only for guidance and do not constitute any part of an offer or contract. Intending purchasers should not rely on them as statements of representation of fact, but must satisfy themselves by inspection or otherwise as to their accuracy. No person in this firm's employment has the authority to make or give any representation or warranty in respect of the property.

138 Shenley Road, Borehamwood, Hertfordshire WD6 1EF

Tel: 020 8953 1818 Fax: 020 8953 0808

Email: info@carrington-borehamwood.co.uk Website: www.carrington-borehamwood.co.uk



COMPANY DIRECTOR: E. A. HUSSAIN
 REGISTERED ADDRESS: 1 WARNER HOUSE, HARROVIAN BUSINESS VILLAGE,
 BESSBOROUGH ROAD, HARROW, MIDD., HA1 3EX.
 COMPANY REGISTRATION No: 09830132